

HOWARD SMITH WHARVES

EST. 1935

RIVERSHED GUEST ACCESS

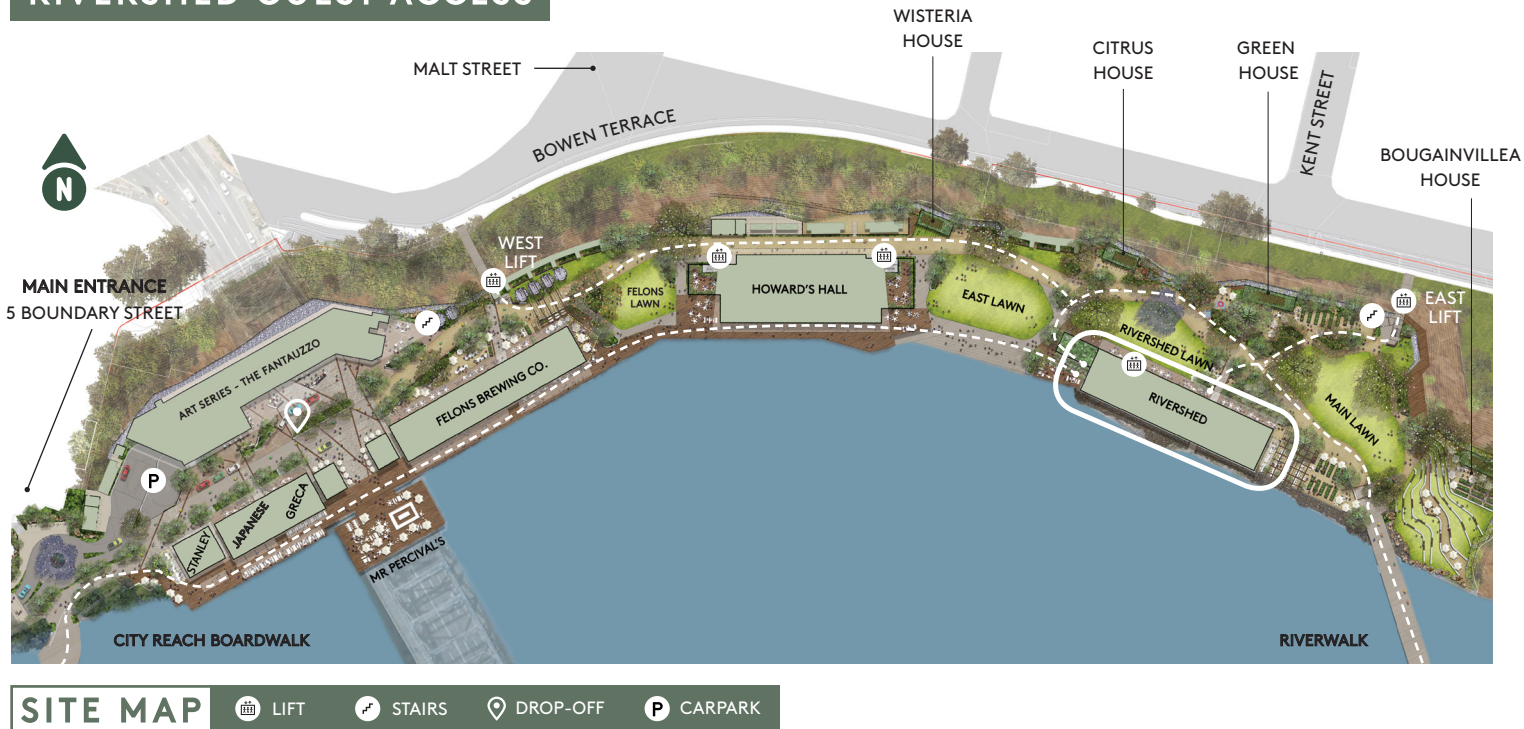

Welcome to **Howard Smith Wharves**, Brisbane's newest entertainment & lifestyle precinct.

Rivershed is rich in character and detail, this heritage wharf building is an inimitable event space with exposed beams and **unparalleled views** of the iconic **Story Bridge** and **Brisbane city skyline**.

As we understand the importance of a smooth and timely guest arrival, please see below the various transportation and access options to Rivershed.



WALKING & CYCLING

Both the City Reach Boardwalk and Riverwalk provide guests arriving by foot or bicycle a pleasant riverside experience avoiding the hustle and bustle of the busy CBD streets. The City Reach Boardwalk connects Howard Smith Wharves with the Riverside and Eagle Street Pier precincts (800m and 950m respectively). The Riverwalk is a 870m overwater shared walkway and cycleway directly joining New Farm and HSW. Guests arriving from the clifftop on Bowen Terrace are encouraged to use the East Lift for access to Rivershed.



CAR

Guest set-down is available at the drop off point in front of the Hotel. This can be accessed by the main entry to the precinct at 5 Boundary Street, Brisbane. Secure Parking operates a public car park offering 350+ bays. Book online prior to arrival to ensure you secure a space and receive discounted rates.

<https://secureaspot.secureparking.com.au/>



TAXI OR RIDESHARE

Direct drivers to Bowen Terrace (corner of Kent Street) and take the East lift from the clifftop down to the precinct. Alternatively, there is a set down zone available at the drop off point in front of the Hotel which is accessible by the main entry to the precinct at 5 Boundary Street, Brisbane.



CITYCAT

OR CITY HOPPER

Take a trip along the River, visit [TransLink](#) for timings to Eagle Street Pier or Riverside Terminal with a short walk to HSW.

If you have time before or after your event there is plenty to experience at HSW. We can't wait to welcome you to Howard Smith Wharves!

WWW.HOWARDSMITHWHARVES.COM