

Call for expressions of interest

GREENOUGH HOTEL

GREENOUGH FLATS

Redevelopment and Partnership Opportunity



VIEW FROM NORTH-EAST



GROUND FLOOR PLAN

0m 5m

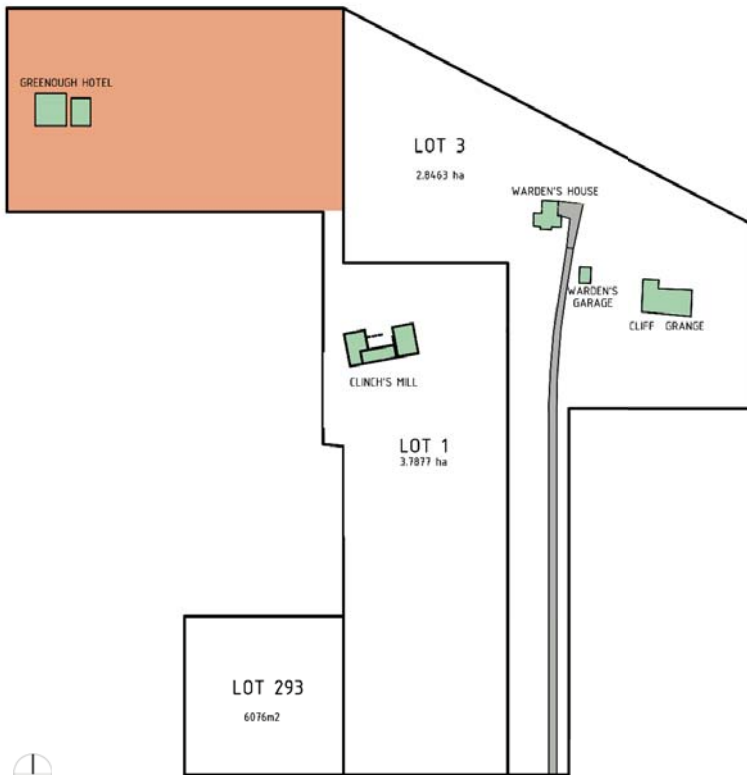

SITE PLAN

PROPOSED LEASE AREA



VIEW FROM SOUTH-WEST



INTERNAL VIEW

Greenough Hotel

Lot Details

9 Gregory Rd, Greenough
Lease part of Lot 1 on Deposited Plan 49220
License for conditional access to other areas of
Lot 1 and Lot 3 PD 64228 (common road)
1.6748 hectares *approximate*

Heritage listings

State Register of Heritage Places number 01143
Municipal Inventory place 30 category 1

Use

Proponents are encouraged to discuss any proposals with the City of Greater Geraldton as well as the National Trust of Western Australia. The National Trust encourages compatible uses that respect the cultural significance of the place. All use proposals will be considered subject to planning and heritage considerations

Summary

Greenough Hotel, a late nineteenth century former hotel also known as Mill Farm, comprises two adjacent buildings of the Victorian Georgian Style which have stone, brick and render walls and chimney and roofs clad in corrugated iron. It has been vacant for many years.

It is significant for the following reasons:

The buildings form a component of an historic precinct characterised by a homogeneity of materials and forms;

The picturesque quality of the buildings located adjacent to one another within the setting of a windswept paddock contributes to the community of Greenough's sense of place;

The place demonstrates the civic development on the Front Flats of Greenough in the year prior to the opening of the railway to Walkaway.

Its historical use during the late nineteenth and early twentieth centuries, as a venue for various civic functions and social events over time when hotel and Residence; and,

The place is representative of a wayside inn of the nineteenth century – a use enriched by its occasional civic uses as court, lock-up, church, Sunday school and venue for numerous balls and dinners.

The landmark relationship between the place and Clinch's Mill to the south-west a relationship reinforced by the naming of the former Greenough Hotel, Mill Farm by the Mills owner: and,

For its association with Arthur Clinch and his descendants, and the place's consequent adaptation to a farmhouse.

[State Register of Heritage Places Register Entry]

The building is generally in a fair condition however considerable work is required to bring it to a usable state. Power supply, communications, water supply and sewer/septic systems will require installation and/or upgrading depending on user requirements.